

HEAT EXCHANGERS

B3-115A Series Heat Exchanger

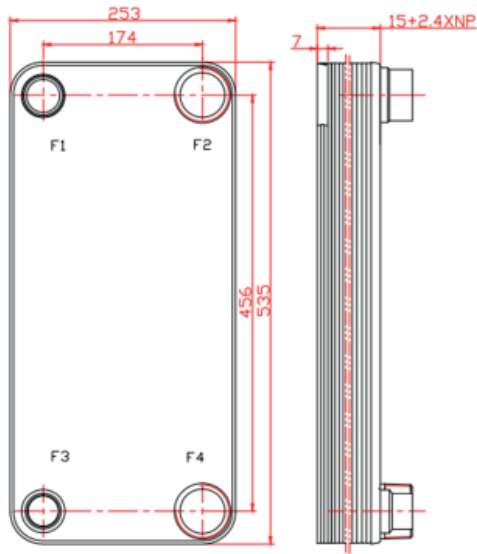

Specification:

- Maximum plate number : 286 pcs
- Max. flow rate: 45 m³/h (198GPM)
- Thickness of one plate: 0.4mm (0.016inches)
- Unit heat exchanger area: 0.115m² (1.24sq.ft)
- Maximum pressure: 3.0Mpa or 4.5Mpa
- Test pressure: 4.5Mpa or 6.0Mpa
- Volume per channel: 0.25 L/channel
- Soldering material: 99.9% copper
- Material: 316 or 304 Stainless Steel
- Operating temperature: -50°F +250°F

Threaded connector: 1", 1-1/2" , 2" M or F NPT

Model Number	Total Heat Area		Height		Weight		Volume	
	m ²	sq.ft	mm	Inch	Kg	lbs	L	US Gal
B3-115A-20	2.1	22.3	63.0	2.5	22.5	49.6	5.3	1.4
B3-115A-30	3.2	34.7	87.0	3.4	26.7	58.9	8.1	2.1
B3-115A-40	4.4	47.0	111.0	4.4	31.0	68.3	10.9	2.9
B3-115A-50	5.5	59.4	135.0	5.3	35.2	77.6	13.7	3.6
B3-115A-60	6.7	71.8	157.0	6.2	39.4	87.0	16.5	4.4
B3-115A-70	7.8	84.2	183.0	7.2	43.7	96.3	19.3	5.1
B3-115A-80	9.0	96.6	207.0	8.2	47.9	105.6	22.1	5.8
B3-115A-90	10.1	108.9	231.0	9.1	52.2	115.0	24.9	6.6
B3-115A-100	11.3	121.3	255.0	10.0	56.4	124.3	27.7	7.3
B3-115A-120	13.6	146.1	303.0	11.9	64.9	143.0	33.3	8.8
B3-115A-180	20.5	220.3	447.0	17.6	90.3	199.1	50.1	13.2
B3-115A-220	25.1	269.9	543.0	21.4	107.3	236.5	61.3	16.2
B3-115A-260	29.7	319.4	639.0	25.2	124.2	273.9	72.5	19.2
B3-115A-286	32.7	351.5	701.4	27.6	135.3	298.3	79.8	21.1